



CUMBERLAND SCHOOL DISTRICT

INVESTING IN OUR **SCHOOLS** OUR **COMMUNITY** OUR **FUTURE**

SCHOOL FACILITY BOND VOTE | TUESDAY, FEBRUARY 20, 2024

The Cumberland School District has spent the past several years studying the needs of our facilities and infrastructure. After an in-depth facility assessment, analysis of educational needs, and a community-wide survey, a plan has been developed to update the High School campus to position our District for the future.

The District is asking community members to vote on a \$32.95 million bond referendum on Tuesday, February 20, 2024.

CURRENT HIGH SCHOOL BUILDING CHALLENGES



Failing Pipes with Asbestos



Exterior Envelope & Structural Issues

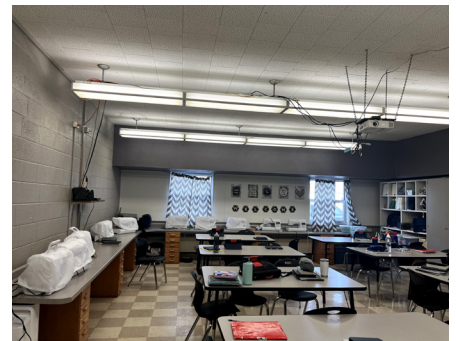

Outdated Classrooms



Failing Interior Finishes



Inefficient Academic Space



Inadequate CTE Spaces



Failing HVAC Systems

LEARN MORE

Community Meetings & Building Tours

- January 8th at 6 pm
- January 22th at 6 pm
- February 5th at 6 pm

Cumberland High School
1000 8th Avenue
Cumberland, WI 54829

SCAN HERE
to visit the
District's
website for
more
information.

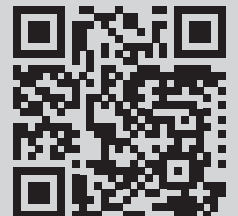

WHAT PROJECTS WILL BE COMPLETED WITH THE BOND?

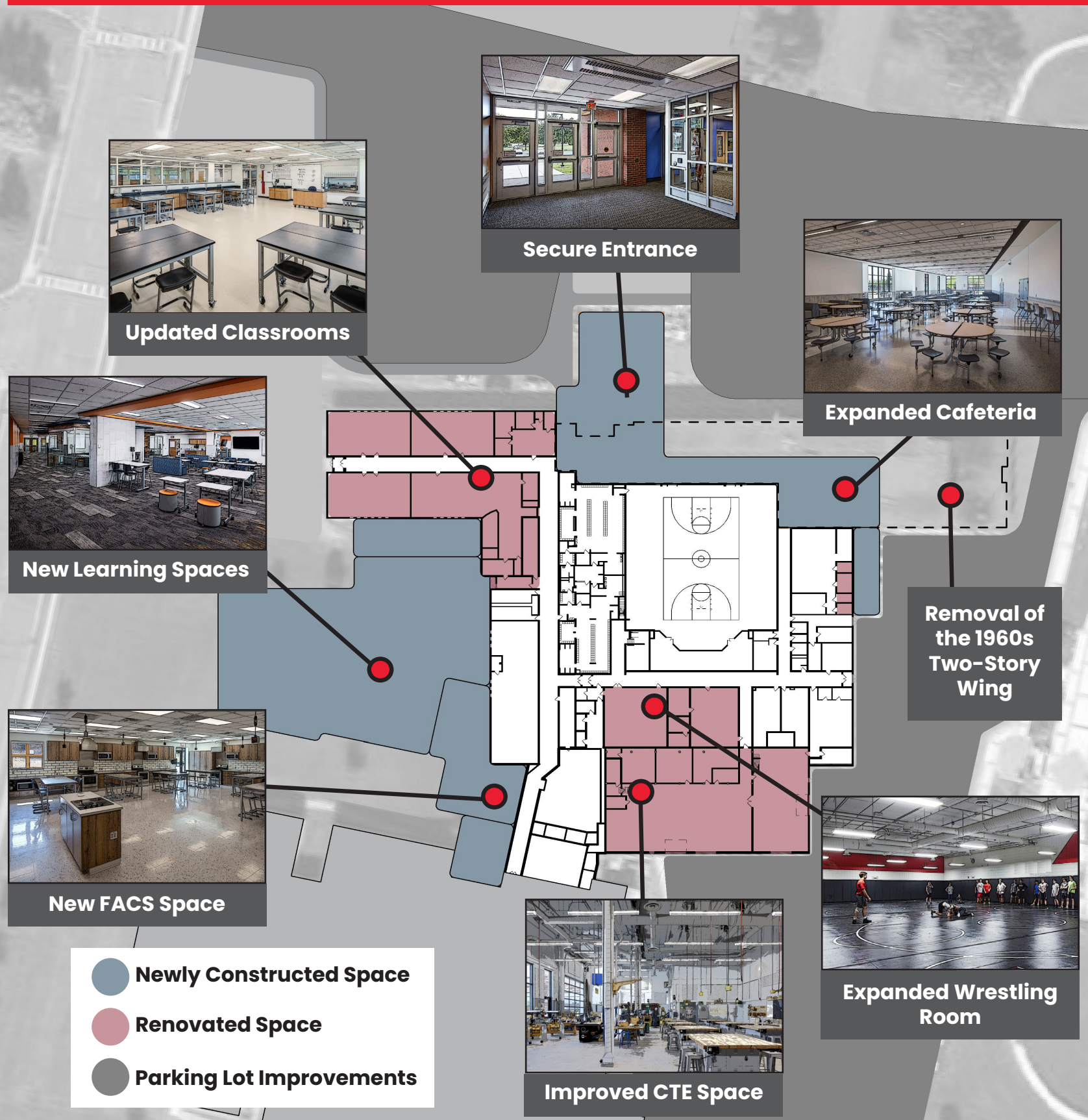

Conceptual images to indicate general project scope



Update Outdated and Failing Building Systems

- The school's heating and ventilation systems are 65 years old and are beginning to fail, with parts no longer available for repair.
- Air handling units will be replaced to enhance indoor air quality.
- The original steam boiler room will be replaced with a new hot water boiler to achieve more consistent temperatures, improved reliability, and increased efficiency.
- The original electrical systems and components are beginning to fail and will be replaced for safety.
- Appropriate measures will be taken to safely remove asbestos from mechanical pipes and throughout the school.



Construct a Secure Entrance and Improve Parking Lot Safety

- Redesign the front entrance and parking lot to improve operational efficiencies; routing visitors through the main office for check-in before entering the school.
- Reconfigure the parking lot and bus/parent drop-off to improve traffic safety at the High School and Middle School.



Expand Commons and Cafeteria/Food Service Space

- Expand the Commons area to improve the flow of student traffic.
- Expand the Cafeteria and food serving area addressing its current undersized configuration to better accommodate students, staff, and delivery services.



Replace the Outdated and Failing 1960s Two-Story Wing with a New Academic Addition

- Construct adequately sized classrooms to replace the current 1960s wing.
- Integrate more flexible learning spaces to meet the educational needs of both students and staff.
- Incorporate Family and Consumer Science (FACS), Art, and Special Education classrooms into the new academic addition to better accommodate the needs of our students, staff, and community.



Renovate the West Wing

- Renovate outdated classrooms into modern Science labs.
- Remodel the Media Center to create a more modern and flexible learning space.



Modernize Career and Technical Education Classrooms

- The High School's Career and Technical Education (CTE) classrooms (shop area) require updates to provide relevant and effective educational experiences.
- Improvements are necessary to enhance training spaces for students entering the workforce. The District has engaged in discussions with businesses to better understand local and industry needs.



Expand the Wrestling Room

- The Wrestling Room is undersized to accommodate the number of student athletes in the program. To address this, the room will undergo expansion by repurposing existing space, creating a larger and safer multi-use practice area.



Cumberland School District
1010 8th Avenue
Cumberland, WI 54829

Permit No. 62
Cumberland, WI
54829
NON-PROFIT

Mail Me HERE
Address
Cumberland, WI 54829

WHAT WILL THIS REFERENDUM COST ME?

ESTIMATED TAX IMPACT	FAIR MARKET VALUE	MAXIMUM TAX IMPACT BEGINNING IN 2024-25	
		ANNUAL	MONTHLY
	\$100,000	\$198.00	\$16.50
	\$200,000	\$396.00	\$33.00

Assumptions: Impact represents an estimate of the maximum projected annual mill rate for referendum approved debt service beginning in 2024-25 with an amortization of 25 years. For more information, visit our District website.



Scan here to visit
the tax calculator:

BALLOT QUESTION

Shall the Cumberland School District, Barron, Polk and Burnett Counties, Wisconsin be authorized to issue pursuant to Chapter 67 of the Wisconsin Statutes, general obligation bonds in an amount not to exceed \$32,950,000 for the public purpose of paying the cost of a school addition and improvement project at the High School/Middle School campus to include: renovations and construction of academic spaces and support areas; partial removal of the current High School building; safety, security, technology, capital maintenance and building infrastructure improvements; ADA accessibility updates; site improvements; and acquisition of furnishings, fixtures and equipment?

VOTE ON ELECTION DAY: TUESDAY, FEBRUARY 20, 2024

For questions regarding your polling location, contact your City/Town Clerk or My Vote Wisconsin at: www.myvote.wi.gov.

City of Cumberland

Arlene Frisinger
715-822-2752

Town of Almena

Kristen Moen
715-554-3107

Town of Bear Lake

Lisa Blechinger
612-860-3340

Town of Clinton

Melanie Miller
715-418-0210

Town of Crystal Lake

Arlene Frisinger
715-822-8039

Town of Cumberland

Holly Nyhus
715-357-6154

Town of Johnstown

Deanne Moravitz
715-497-3043

Town of Lakeland

Danielle Maxwell-Parker
715-822-2775

Town of Maple Plain

Danielle Maxwell-Parker
715-529-2741

Town of McKinley

Anna Weaver
715-296-6722

Town of Roosevelt

Kate Odden
319-721-1282

Town of Stanfold

Kris Foust
715-475-9363



District Office
715-822-5124



Superintendent, Dr. Barry Rose
brose@csdmail.com
Steve Mann
smann@csdmail.com



cumberlandsd



www.cumberland.k12.wi.us/referendum-2024/



cumberlandschool